

AMENDMENT TO CONDOMINIUM DECLARATION  
OF MARSH LANDING TOWNHOUSE CONDOMINIUM  
4108881

This Amendment to that certain Condominium Declaration for Marsh Landing Townhouse Condominium, as recorded in O.R. Book 2786, Page 1493, Public Records of Lee County, Florida, is made by the undersigned Developer.

NOW, THEREFORE, the undersigned hereby amends the Condominium Declaration as follows:

1. Phase 2 of the Condominium now being completed on the property described on attached Exhibit "A" is hereby submitted to the condominium form of ownership thereby making such Phase a part of Marsh Landing Townhouse Condominium.
2. The share of the common elements, common expenses and common surplus attributable to each unit upon the addition of Phase 2 is a fraction, the numerator of which is one and the denominator of which is eight.
3. The survey and plot plan and the surveyor's certification are attached hereto as Exhibits "B", "C" and "D", each of which describe the Phase being hereby submitted. The units are designed thereon by building number (phase) and unit number.
4. In all other respects, the Condominium Declaration, as previously amended, remains in full force and effect and unchanged.

IN WITNESS WHEREOF, the undersigned Developer has caused this Amendment to the Declaration of Condominium of Marsh Landing Townhouse Condominium to be executed by its duly authorized officer this 5th day of February, 1997.

WITNESS:

DEVELOPER: ROTTLUND HOMES OF FLORIDA, INC., a Minnesota corporation

[Signature]  
[Signature]

By [Signature]  
Its \_\_\_\_\_ President

STATE OF FLORIDA  
COUNTY OF LEE

The foregoing instrument was acknowledged before me this 5th day of February, 1997, by Robert [Signature] President of Rottlund Homes of Florida, Inc., a Minnesota corporation, on behalf of the corporation. He is personally known to me or has produced \_\_\_\_\_ as identification.

[Signature]  
Notary Public, State of Florida  
Print Name TRAVIS SKIFFER

RECORD VERIFIED - CHARLIE GREEN, CLERK  
BY HELEN CARROLL, P.C.

DR2789 PG3005

LEGAL DESCRIPTION  
MARSH LANDING TOWNHOUSE CONDOMINIUM  
PHASE 2

A portion of Tract C, "MARSH LANDING" as recorded in Plat Book 58 at Page 42 of the Public Records of Lee County, Florida, being more particularly described as follows:

COMMENCE at the Northeast Corner of said Tract C; thence S22°02'26"W a distance of 494.99 feet to the POINT OF BEGINNING; said point lying on the arc of a circular curve concave to the West; thence Southerly along the arc of said curve having for its elements a radius of 546.00 feet, a central angle of 09°47'39", an arc distance of 93.33 feet, a chord distance of 93.22 feet and a chord bearing of S02°52'07"W to a point of tangency; thence S07°45'57"W a distance of 11.42 feet; thence N82°14'03"W a distance of 88.76 feet; thence N00°34'40"E a distance of 89.13 feet; thence N87°58'18"E a distance of 93.31 feet to the POINT OF BEGINNING.

Containing 8,952.176 square feet, more or less.

OR2789 PG3006

# MARSH LANDING TOWNHOUSE CONDOMINIUM

NOVEMBER 1996

OR2789 PG3007

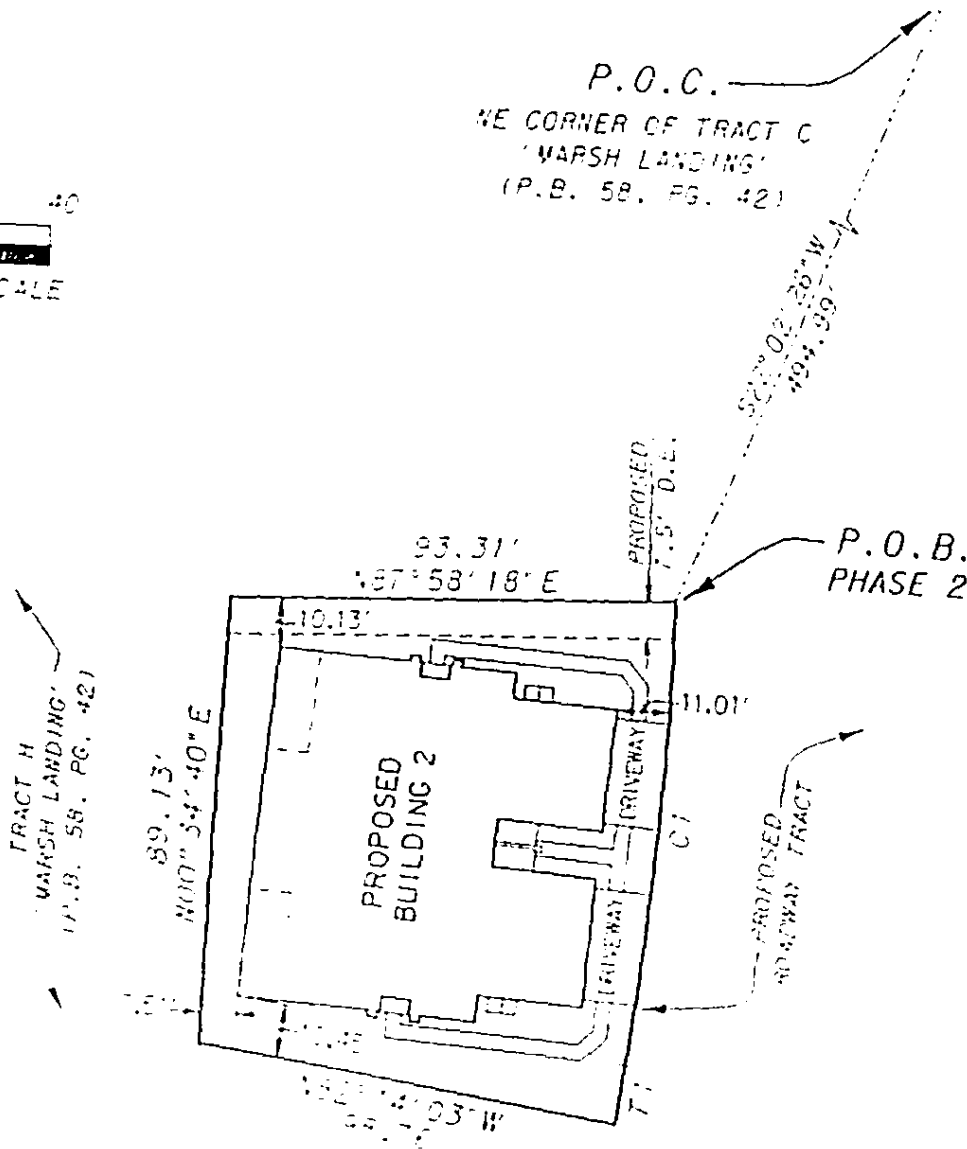
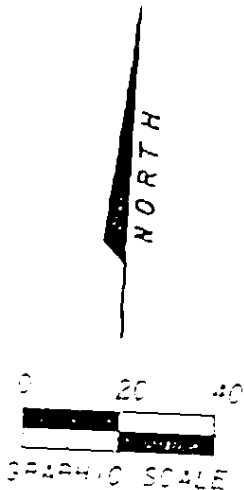

TANGENT TABLE		
NO.	BEARING	DISTANCE
1	S0°45'57\"/>	





# MARSH LANDING TOWNHOUSE CONDOMINIUM

NOVEMBER 1996

OR2789 PG3010

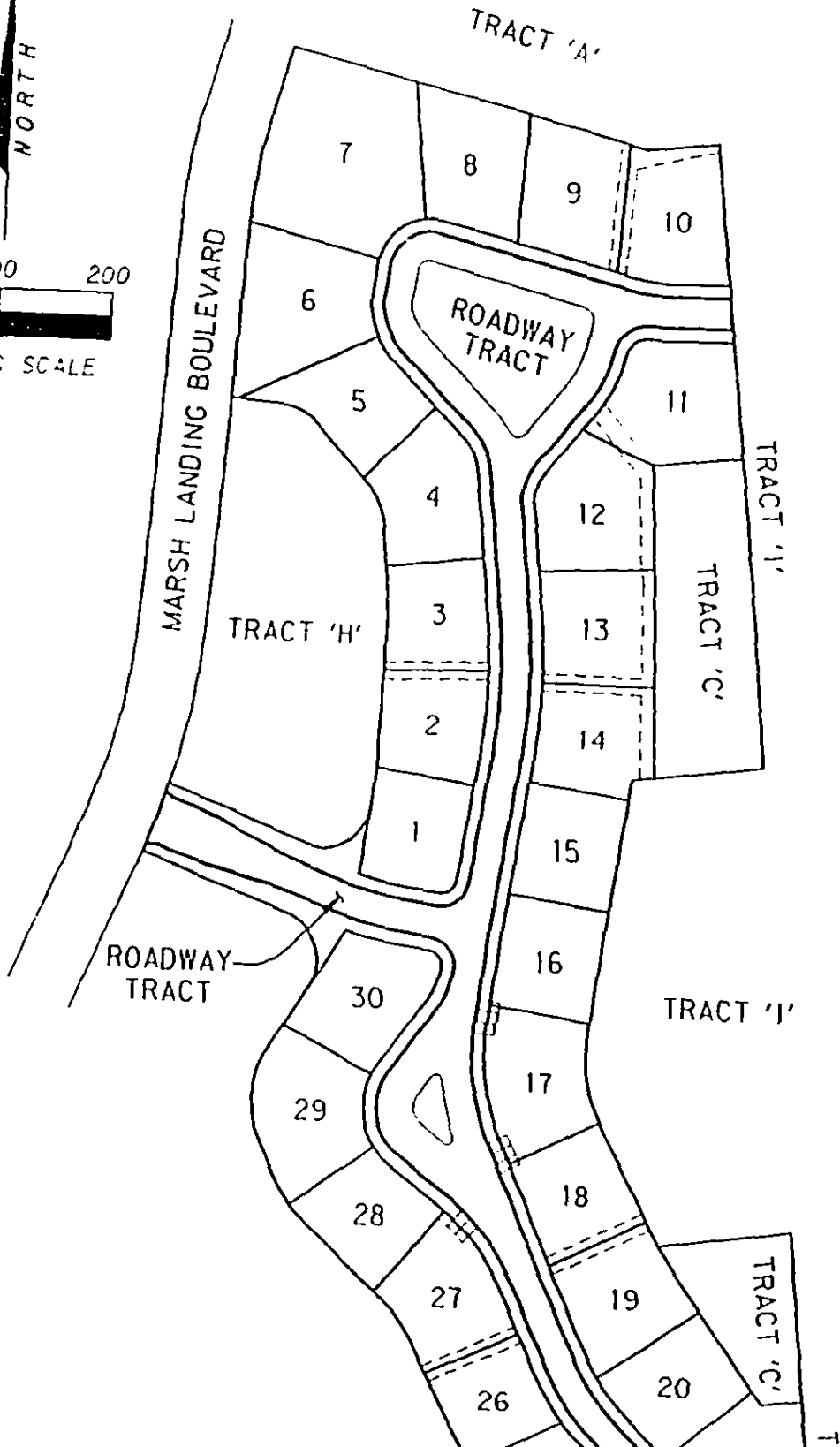
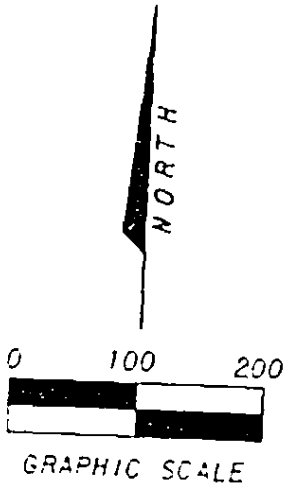

97FEB -6 PH 4: 02

MARSH LANDING TOWNHOUSE CONDOMINIUM

SURVEY CERTIFICATION

We hereby certify pursuant to Section 718.104(4)(e) F.S. as amended that the construction of the improvements shown on the attached exhibits is substantially complete; so that such material together with the provisions of the Declaration of Condominium of Marsh Landing Townhouse Condominium describing the condominium property is an accurate representation of the locations and dimensions of the improvements and that the identification, location and dimensions of the common elements and of each home can be determined from these materials.

POST, BUCKLEY, SCHUH & JERNIGAN, INC.

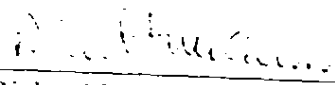
  
Richard L. McCarrier  
Registered Land Surveyor #3875  
State of Florida

OR2789 PG30111

